

### Regular Pattern

500 CWP (34.5 bar)

1000 psig (69.0 bar) Test

Figure 524 – Threaded, Wrench-Operated, Sizes ½ through 4

Figure 525 – Flanged, Wrench-Operated, Sizes 1 through 4

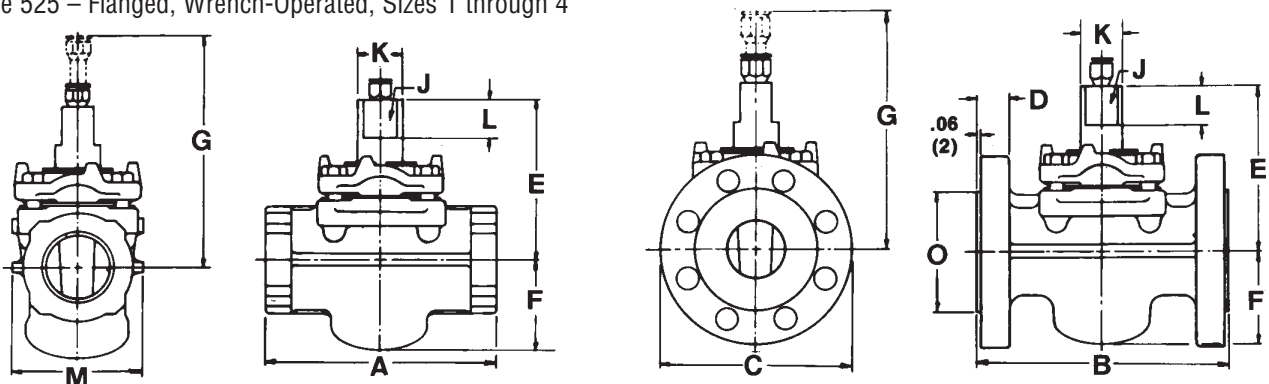

| Size   | NPS<br>DN | ½<br>15    | ¾<br>20    | 1<br>25     | 1¼<br>32    | 1½<br>40    | 2<br>50     | 2½<br>65    | 3<br>80      | 4<br>100     |
|--|-----------|------------|------------|-------------|-------------|-------------|-------------|-------------|--------------|--------------|
| End-to-end, threaded, Figure 524                           | A         | 3.75<br>95 | 3.75<br>95 | 4.88<br>124 | 5.38<br>137 | 6.75<br>171 | 8.00<br>203 | 9.50<br>241 | 9.38<br>238  | 10.50<br>267 |
| Face-to-face, flanged (include ¼" raised face), Figure 525 | B         |            |            | 6.25<br>159 |             | 7.50<br>191 | 8.50<br>216 | 9.50<br>241 | 11.13<br>282 | 12.00<br>305 |
| Diameter of flange   | C         |            |            | 4.9<br>124  |             | 6.1<br>155  | 6.5<br>165  | 7.5<br>191  | 8.3<br>211   | 10.0<br>254  |
| Thickness of flange (include ¼" raised face)               | D         |            |            | .75<br>19   |             | .94<br>24   | 1.06<br>27  | 1.19<br>30  | 1.31<br>33   | 1.50<br>38   |
| Center to top of stem                                      | E         | 3.9<br>99  | 3.9<br>99  | 4.1<br>104  | 4.6<br>117  | 4.9<br>124  | 5.7<br>145  | 6.2<br>157  | 7.0<br>178   | 7.5<br>191   |
| Center to bottom of body                                   | F         | 2.0<br>51  | 2.0<br>51  | 2.2<br>56   | 2.5<br>64   | 2.8<br>71   | 3.2<br>81   | 3.7<br>94   | 4.3<br>109   | 4.7<br>119   |
| Clearance required to remove sealant fitting               | G         | 6.5<br>165 | 6.5<br>165 | 6.7<br>170  | 7.2<br>183  | 7.5<br>191  | 8.3<br>211  | 8.8<br>224  | 9.6<br>244   | 10.1<br>257  |
| Width of stem flats  | J         | .81<br>21  | .81<br>21  | .88<br>22   | .94<br>24   | 1.00<br>25  | 1.13<br>29  | 1.25<br>32  | 1.38<br>35   | 1.38<br>35   |
| Diameter of stem   | K         | 1.09<br>28 | 1.09<br>28 | 1.22<br>31  | 1.31<br>33  | 1.41<br>36  | 1.59<br>40  | 1.78<br>45  | 1.97<br>50   | 1.97<br>50   |
| Height of stem flats                                       | L         | .9<br>23   | .9<br>23   | 1.0<br>25   | 1.1<br>28   | 1.2<br>30   | 1.4<br>36   | 1.5<br>38   | 1.8<br>46    | 1.8<br>46    |
| Extreme width of body, Figure 524                          | M         | 3.1<br>79  | 3.1<br>79  | 3.3<br>84   | 3.6<br>91   | 3.9<br>99   | 4.6<br>117  | 5.4<br>137  | 6.0<br>152   | 6.8<br>173   |
| Diameter of ¼" raised face                                 | O         |            |            | 2.6<br>66   |             | 3.5<br>89   | 4.1<br>104  | 4.9<br>124  | 5.6<br>142   | 6.9<br>175   |
| Size of wrench   | —         | D-8        | D-8        | E-8         | H-8         | J-8         | K-8         | L-8         | M-8          | M-8          |
| Length of wrench   | —         | 5.5<br>140 | 5.5<br>140 | 7.0<br>178  | 9.0<br>229  | 10.5<br>267 | 14.0<br>356 | 17.5<br>445 | 21.0<br>533  | 21.0<br>533  |
| Size of Sealant Stick                                      | —         | B          | B          | B           | B           | B           | B           | B           | B            | B            |
| Weight (approx.) Figure 524                                | —         | 6<br>3     | 6<br>3     | 9<br>4      | 13<br>6     | 18<br>8     | 27<br>12    | 43<br>20    | 58<br>26     | 80<br>36     |
| Weight (approx.) Figure 525                                | —         |            |            | 14<br>6     |             | 28<br>13    | 38<br>17    | 56<br>25    | 81<br>37     | 110<br>50    |

Flanges are drilled to ANSI Class 250 Cast Iron Flange Standard Template. For drilling and bolting data, See page 40.

Figures 524 and 525 valves conform to the following standards where applicable: ANSI B1.20.1; ANSI B16.1; ANSI B16.10; API 5B; ASTM A126, Class B; and MSS SP-78. See page 34.

Figure 525 Face-to-face lengths are interchangeable with ANSI Class 250 and API 500 CWP Cast Iron Gate Valves.